



Power switcher

User manual



Dear customer, thank you for your purchase.



English



Table of contents

I. Initial setup.....	3
II. Operating modes of the device.....	7
III. Resetting the device.....	8
IV. Information and warnings.....	9
V. Warranty Conditions.....	11
VI. Technical information.....	14
VII. Knowledge base and technical support.....	15



IMPORTANT! Please read the entire user manual carefully before setting up and using the device. There may be slight differences in the content between what is presented on the device's screen and the manual's descriptions.

I. Initial configuration

To connect the device to your account using the Smart Reef app, the device must be connected to power and within range of your home network, and your phone or tablet. You can download the app from the Play store and the App store.

1. open the Smart Reef app on your mobile device and log in.

If you do not already have a Smart Reef account, select **“Create a free account”**.

Enter the email address you want to use in the Smart Reef application as well as the password, and then repeat it.



If you don't want to, log in every time you launch the application, check **“Keep me logged in”**.

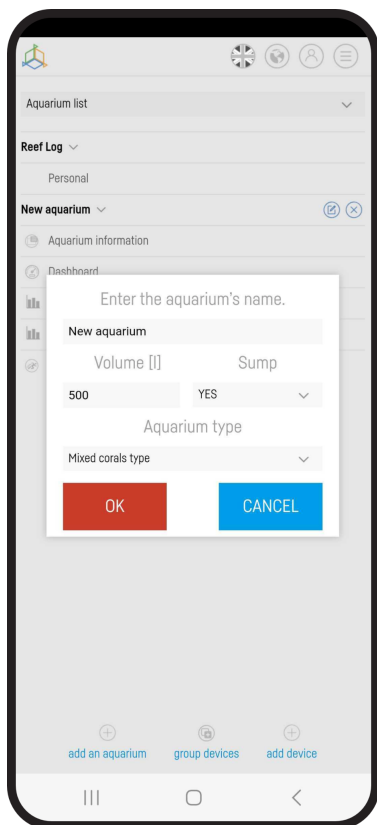
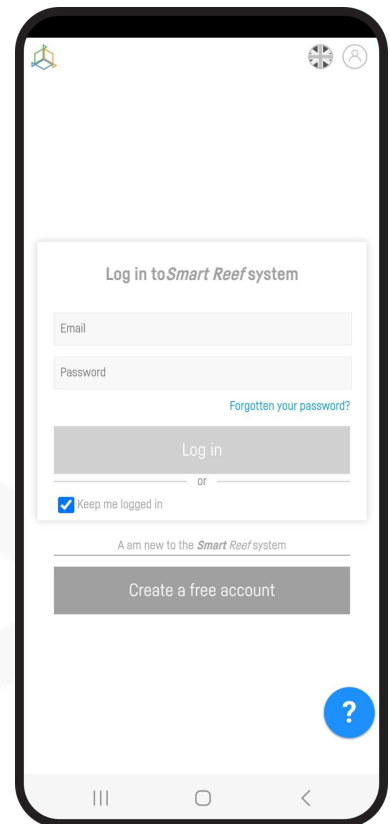

2. Create your aquarium in the Smart Reef app.

If you do not have your aquarium yet, use the option **“Add an aquarium”** in the lower left corner of the screen and provide the necessary information.



If you already have your aquarium in the Smart Reef app, proceed to the next step.

3. Add the device to your Smart Reef account

From the list of aquariums or the list of devices in the lower right corner of the screen, select **“add device.”**

Allow the app to use your exact location when using the app. This allows the app to connect devices to Wi-Fi networks more easily.

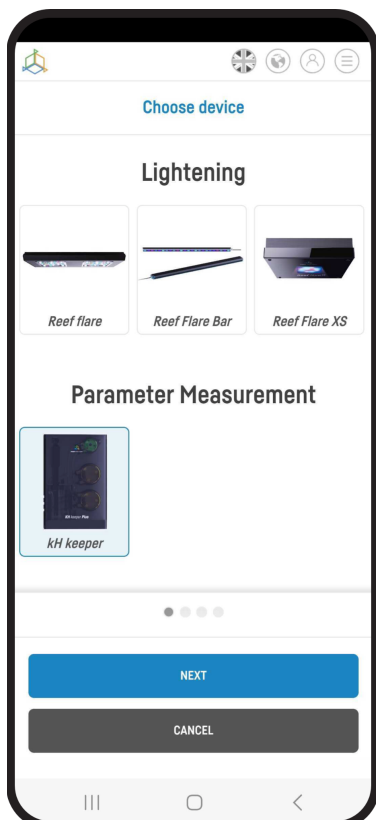
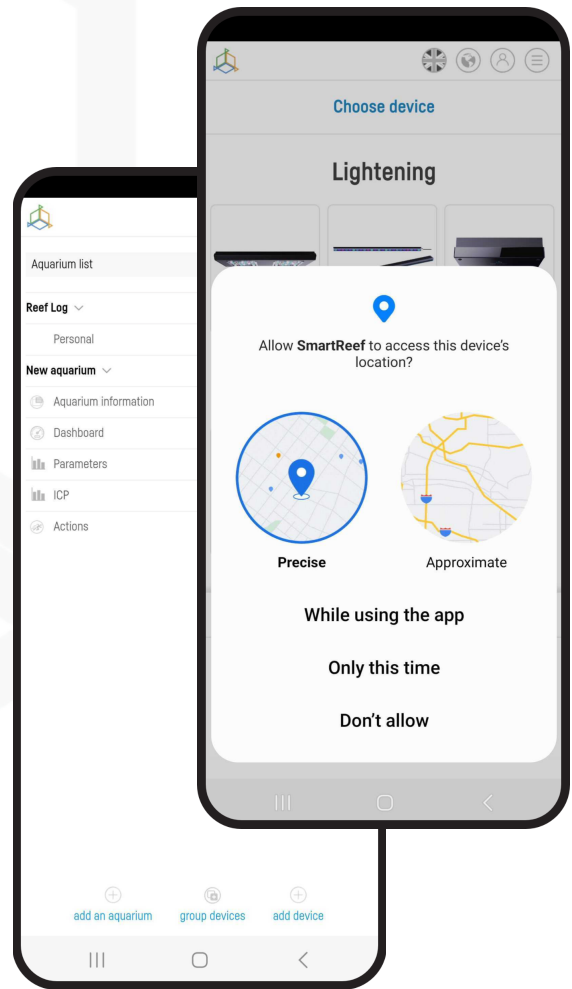

Select from the scrolling list the device you want to add to your Smart Reef account and press **“NEXT”**.

4. Set up a Wi-Fi connection to your home router.

Enter the exact Wi-Fi network name of your home router.

Then enter the password for your home router, if required, and press **"NEXT"**.



Pay attention to uppercase and lowercase characters.

NOTE: Special characters may not be supported if the name or password for your router contains such characters, change them in your router's settings.



NOTE: Reef Factory devices only support the 2.4 GHz Wi-Fi network band. If your router generates 2.4 GHz and 5 GHz bands, indicate the name of the 2.4 GHz network.

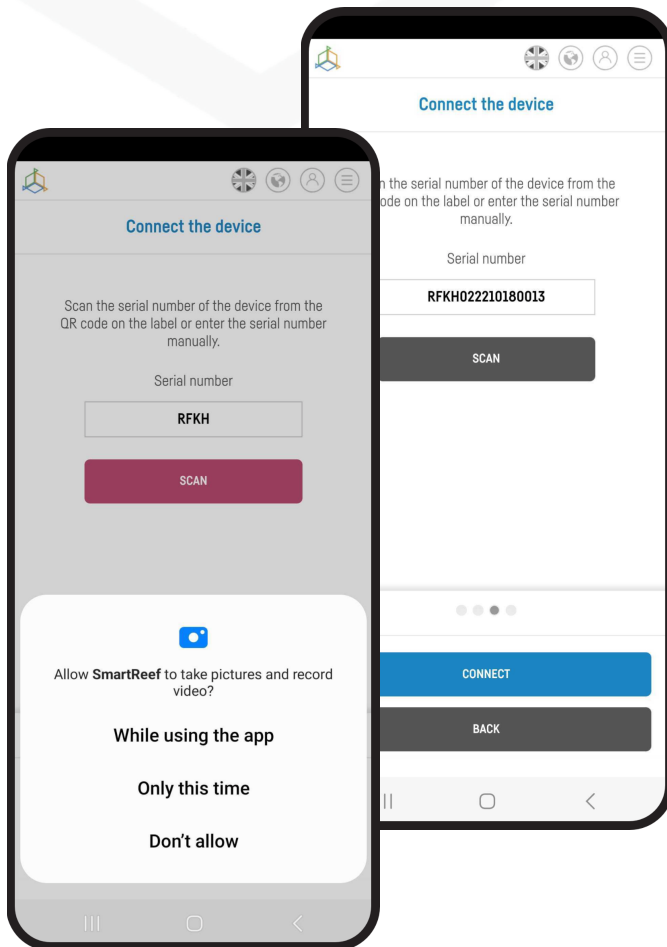
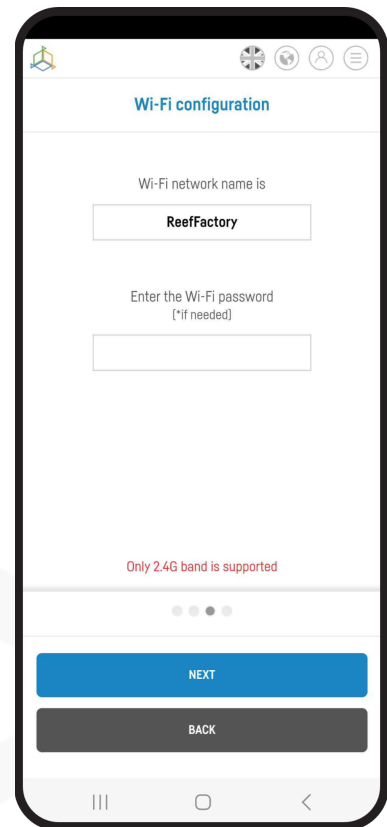

Select **"SCANNING"** to scan the QR code on the device, then allow the Smart Reef app to access the camera while using the app.

After pressing **"SCAN"**, hover your phone's camera over the QR code to scan it, or manually enter the device's serial number and select **"CONNECT"**.



You can find the serial number on the device, on the packaging and as the generated Wi-Fi network.



The serial number starts with RF, an abbreviation of the device name, and a string of digits.

Allow the Smart Reef app, to temporarily connect to set up a Wi-Fi network.

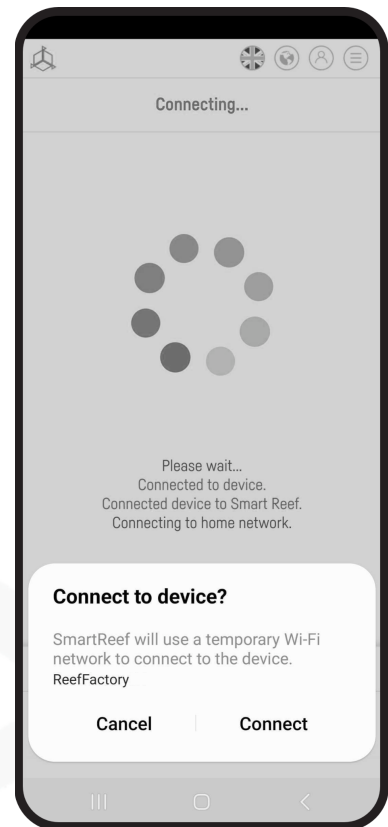

Congratulations! The device has been correctly added to your Smart Reef account and will appear in the list of devices within 60 seconds.

II. Operating modes

After configuring the device, select the mode of operation of the Power switcher. There are two modes to choose from:

Automatic mode

It allows you to set the automatic operation of the device.

The green bars on the timeline indicate periods when the Power switcher is ON (the connected device is powered), and the gaps between them show when the device is OFF (the connected device is not powered).

After selecting the "SETUP" button, we are able to set the exact operating time.

Manual mode - allows you to manually turn the device on or off remotely.

"Active for" is used to set how long the Power switch should operate. When the "Active for" time expires, the Power switch will switch to automatic mode.

You can set the timer to a maximum of 60 minutes. If you set "Active for" to "Always", the Power switch will remain in manual mode until you manually change it.

III. Resetting the device

If your device is not working properly, you want to reconfigure it, or you can't connect to it despite several attempts, you can restore it to factory settings by holding down the device's power button for about 15 seconds.



After resetting the device to factory settings you will need to configure the device again.

IV. Information and warnings



IMPORTANT INFORMATION! The Power switcher is not completely waterproof. Avoid immersion, splashing and high humidity. Exposure to these factors may cause permanent damage to the device.



IMPORTANT INFORMATION! The device operates under mains voltage - there is a risk of electric shock.



IMPORTANT INFORMATION! PACKAGING

The device was protected during transport by packaging. After unpacking the device, please dispose of the packaging in an environmentally friendly manner. All materials used for packaging are harmless to the environment and 100% recyclable. Packing materials (polyethylene bags, foams, bundle wires, etc.) should be kept away from children during unpacking. There is a risk of swallowing, aspiration and suffocation.



IMPORTANT INFORMATION! WITHDRAWAL FROM OPERATION

The device is marked in accordance with the European Directive 2012/19/EU and the Polish Act on waste electrical and electronic equipment with the symbol of a crossed-out waste container. Such marking informs that after the period of its use, this equipment cannot be placed together with other household waste. The user is obliged to hand it over to the waste electrical and electronic equipment collection centers. The collectors, including local collection points, shops and communal units, create an appropriate system enabling the disposal of this equipment. Proper handling of waste electrical and electronic equipment contributes to avoiding consequences harmful to human health and the natural environment, resulting from the presence of hazardous components and improper storage and processing of such equipment.

1. The manufacturer of the devices described in this manual is:

Reef Factory Sp. z o

. ul. Bydgoska 94

86-032 Niemcz

Poland

Manufacturer's website: www.reeffactory.com

2. The manufacturer declares that the offered products comply with the following standards:

RoHS 2011/65/EU,

RoHS 2015/863,

RED 2014/53/EU.

3. Reef Factory hereby declares that the devices are in compliance with Directive 2014/53/EU.

Full text of the EU declaration of conformity is available at the following internet address:

<https://download.reeffactory.com/instructions/powerswitcher/PowerSwitcherCE.pdf>

And also on the product page <https://www.reeffactory.com/powerswitcher>
under the "Tech specs", tab in the "CE Declaration of Conformity" section.

4. Devices manufactured by Reef Factory are intended only for home use or stores operating in the aquarium industry , they are not dedicated to industrial applications.

5. The devices are adapted to dispensing liquids that are not hazardous substances, such as corrosive substances, highly concentrated acids or flammable substances. In case of doubt whether a given substance can be dosed using our devices, please contact us.

V. Warranty conditions

Reef Factory Sp. z o. o. does not warrant uninterrupted or error-free operation of this product. The warranty covers only technical hardware problems that occurred within the warranty period and under normal conditions of use.

1. Devices manufactured by Reef Factory are covered by a warranty for the period of:
 - 24 months for individual and business customers using consumer products.
 - 12 months for a business customer using demo products.
2. The accessories and spare parts for the devices are covered by a 6-month warranty.
3. The proof of the warranty for the product is the bill or invoice of purchase, on which the date of purchase and the name of the device are legibly marked.
4. Technical defects of the product revealed during the warranty period will be removed free of charge as soon as possible, not exceeding 14 days from the date of delivery of the device to the Authorized Service Center.
5. The User has the right to replace the product by the Guarantor with a new one, free from defects, in the event that:
 - Five repairs requiring replacement of components were made during the warranty period, and the product still shows defects,
 - The Authorized Service Center stated in writing that the defect is impossible to remove.
6. The condition for the warranty repair is:
 - Delivery of the product in the original factory packaging or other packaging protecting the device during transport to the Authorized Service Point.
 - Presentation of a copy of the original proof of purchase,
 - Description of the fault that occurs in the device.

1. warranty does not cover:
 - Normal wear and tear of materials and consumables (e.g. consumables such as probes, sensors, pump heads, hoses, etc.),
 - Mechanical damage and defects caused by it,
 - Damage caused by improper use or product storage,
 - Damage resulting from arbitrary repairs and alterations made by the Buyer or unauthorized persons,
 - Damage resulting from natural wear and tear, such as: scratches, dirt, abrasions, erasure of inscriptions, etc.
2. Employees of the Authorized Service Center are authorized to assess the causes of product defects.
3. The repair period may be extended in the event of disruptions caused by force majeure circumstances such as natural disasters, civil unrest, etc.
4. The warranty entitlements do not include the buyer's right to claim lost profits or losses incurred due to product defects.
5. The warranty period is extended by the time the device is in an authorized service center.
6. In matters not covered by the terms of this guarantee, the relevant provisions of the Civil Code shall apply.
7. The warranty does not exclude, limit or suspend the buyer's rights under the provisions on warranty for defects in the sold item.
8. A repaired or replaced product may contain new or refurbished components.
9. Please be advised that the repair or replacement of a product involves a significant risk of losing data stored in a given product (especially related to its configuration and history of measurements). Therefore, the Customer accepts that during the repair or replacement of the product, the data may be deleted.
10. The Guarantor is not responsible for the lack of full compatibility (compatibility) of the product in operation with accessories or devices from other manufacturers used by the Customer. In particular, this applies to network devices whose configuration may limit the ability to connect and exchange data between the device and the server.
11. The customer delivers the device for repair to the Authorized Service Center at his own expense, while the service, after performing the warranty repair, sends the device back to the customer at his own expense.

12. The Authorized Service Point may repair/reconstruct the device at the Customer's expense (post-warranty repair), however, the Customer must accept this cost before repairing it.
13. The Authorized Service Point may refuse to repair or replace a device that, after testing in service conditions, does not show any defects for the product in terms of its use (confirmation of the device's full efficiency).
14. The Authorized Service Center may refuse to repair or replace a device that has a damaged or illegible serial number label.
15. The Guarantor is not liable for incidental or consequential damages caused by breach of warranty or conditions or any other theory of law, including but not limited to loss of usability; loss of income; loss of actual and perceived profits (including loss of profits from contracts); loss of business; loss of opportunities; impairment of the company's value; loss of reputation.
16. The Guarantor is not liable for direct or indirect damages caused as a result of a defect or failure of the device and for damages arising during the period of repairs or replacement of the device related to the inability to use the device.

VI. Technical information

Device name	Power Switcher
Device model	RFPS01
Temperatura pracy / wilgotność	10°C – 50°C / 0 – 99%
Maximum power consumption	1W
Power supply	100V-240V AC 50-60Hz
Dimensions (mm)	80x50x50 mm
Weight	100 g

The device is manufactured with different versions of power cables and power sockets, depending on the country in which it will be used.

VII. Knowledge base and technical support

Need our help?

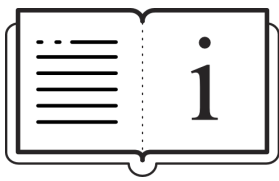

Check out our knowledge base!

[Help Center - Jira Service Management](#)

Do you have more questions?



Use the form in the link above

or write us an email - support@reeffactory.com